

TABEL DE TAMPLARIE - SITUATIE EXISTENTA

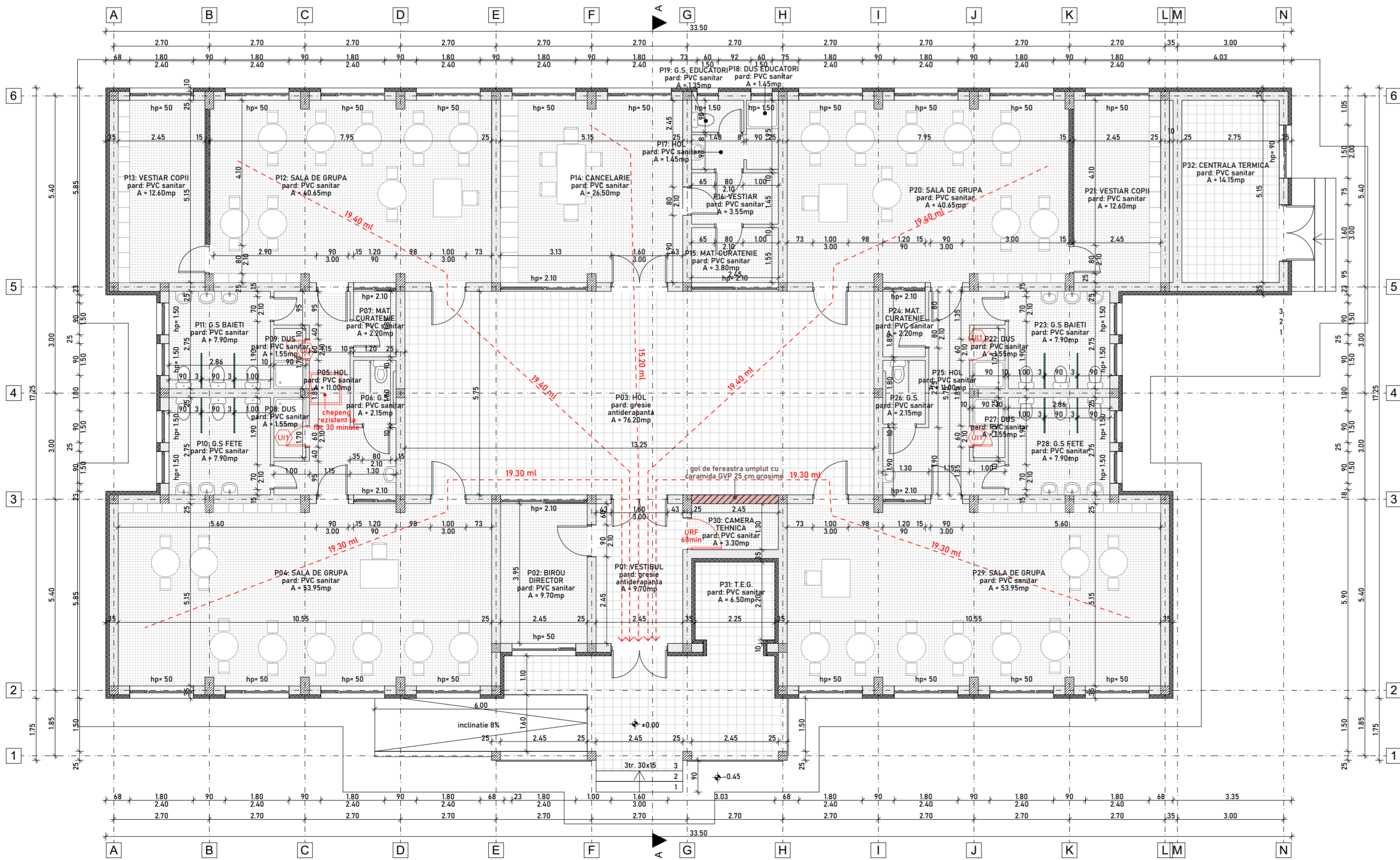

TABLOU DE TAMPLARIE - SITUATIE PROPUSA

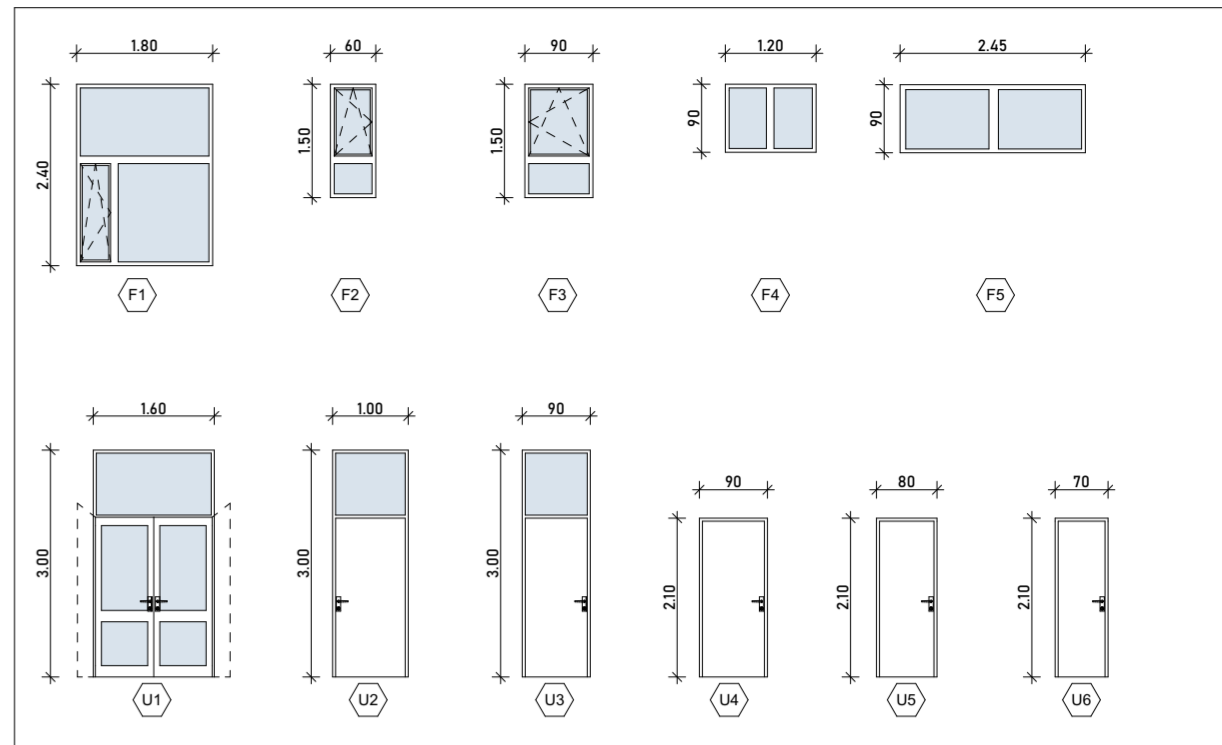
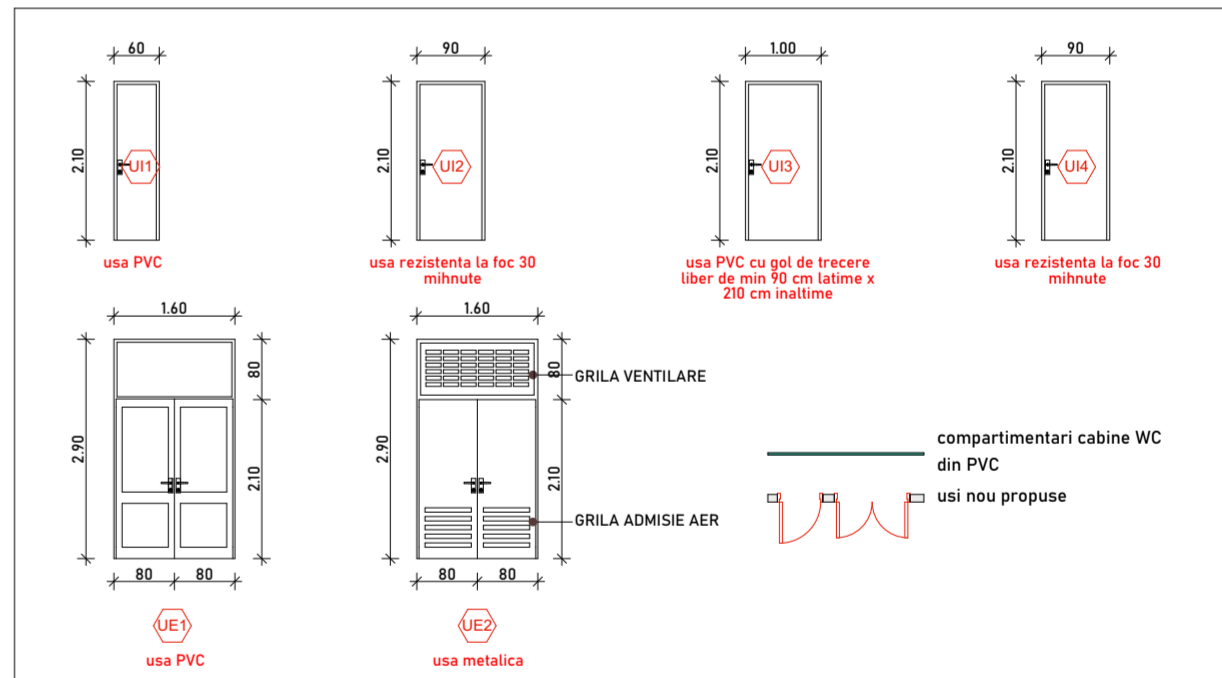

| Indicatori urbanistici:   |             |
|---------------------------|-------------|
| - Suprafata teren         | = 1595.00mp |
| - A construita Gradinita  | = 507.00mp  |
| - A desfasurata Gradinita | = 507.00mp  |
| - Regim de inaltime       | P           |
| - H. min. coama           | = 6,85 m    |
| - H. min. streasina       | = 3,55 m    |
| - P.O.T. propus           | = 31,78%    |
| - C.U.T. propus           | = 0,32      |

conf. P100/2006, imobilul se incadreaza in Clasa III de importanta pentru actiunea seismică  
conf. HGR 766/1997 Categoria de importanta a constructiei este C Normala  
conf. P118.99 art. 2.19, Gradul de rezistenta la foc II

| EXPERT  |  |          |               |   |
|---|--|----------|---------------|---|
| VERIFICATOR   |  |          |               |   |
| SPECIFICATIE  | NUME   | SEMNTURA | SPECIFICATIE  | REFERAT/EXPERTIZA NR./DATA  |
|  | S.C. ISODRAFT STUDIO + S.R.L.<br>Str. Tutovei Nr. 27, Municipiul Bantad, Judetul Vaslui<br>J37/704/2018 - 40014013 - Telefon: 0766/ 676.246<br>Email: isodraftstudio@gmail.com |          |               | DENUMIRE DOCUMENTATIE:<br>"GRADINITA PN, sat RAFAILA, comuna RAFAILA, judetul VASLUI" - REST<br>DE EXECUTAT |
|   | SEF PROIECT arh. ANDREI PICIORLUNG   |          |               | BENEFICIAR:<br>COMUNA RAFAILA, JUDETUL VASLUI   |
| PROIECTAT   | arh. BOGDAN BRINDUSESCU  |          | sc: 1:100     | AMPLASAMENT:<br>SAT RAFAILA, COMUNA RAFAILA, JUDETUL VASLUI   |
| DESENAT   | arh. ANDREI PICIORLUNG   |          | DATA:<br>2020 | TITLU PLANSA:<br>PLAN PARTER / SITUATIE EXISTENTA - SITUATIE PROPUSA  |
|   |  |          |               | Proiect:<br>68/2020<br>Faza:<br>D.T.A.C +<br>P.Th.  |
|   |  |          |               | Nr. Plansa:<br>A.01   |